

IMPERIAL

congress hall

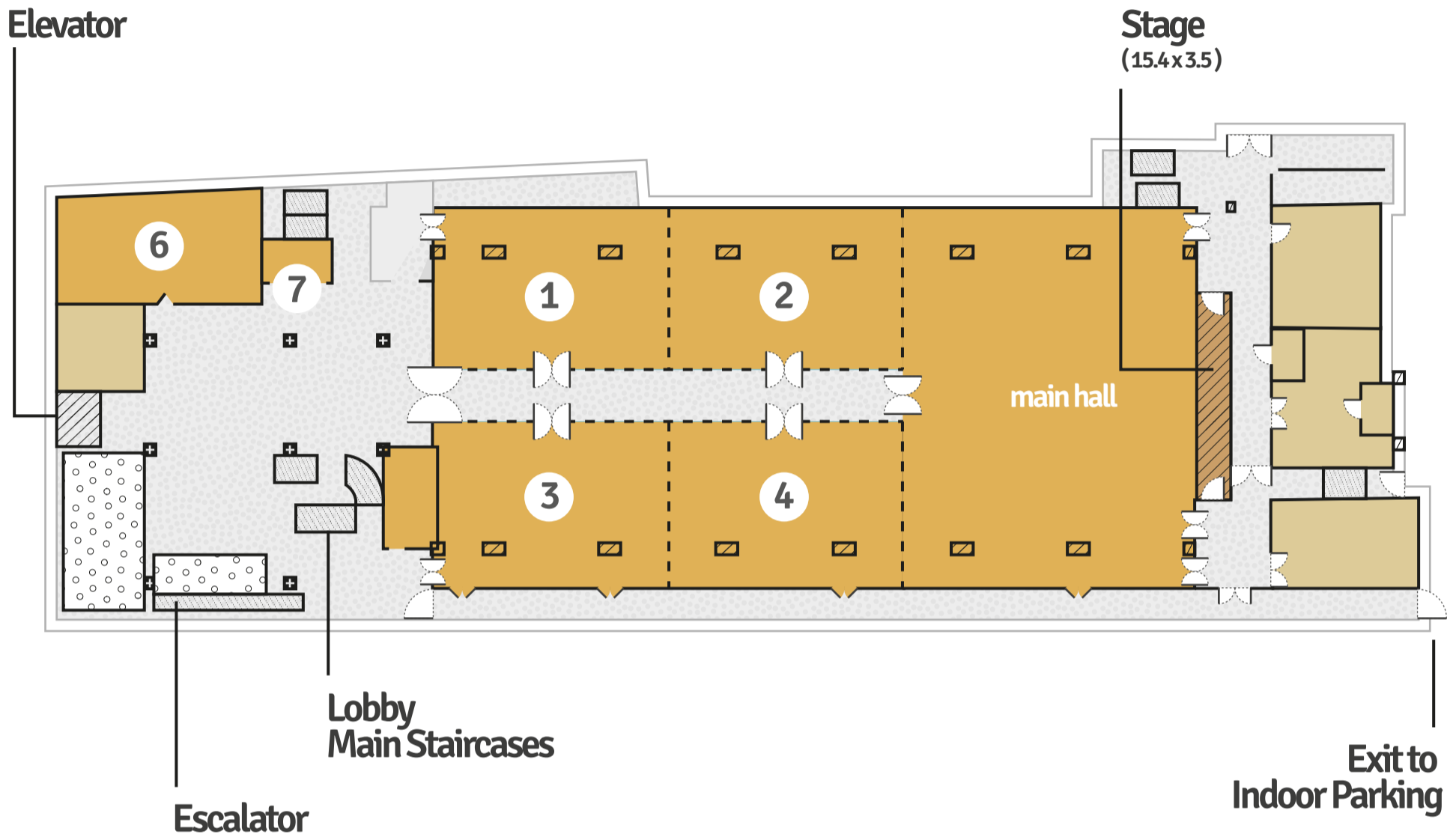

Conference Hall/ Meeting Room	DIMENSIONS				CAPACITIES					LIGHTING	A/C	FLOOR/ COVER
	Surface	Height	Length	Width	Theater	Classroom	U-Shape	Buffet	Cocktail			
IMPERIAL CONGRESS HALL	1510	5.5	54.2	27.83	1600	800	N/A	N/A	1500	Electricity	YES	Ground/Carpet
MAIN HALL	570	5.5	22.2	25.7	670	410	100	N/A	650	Electricity	YES	Ground/Carpet
HALL I 1	170	5.5	16	10.7	200	120	50	N/A	190	Electricity	YES	Ground/Carpet
HALL II 2	170	5.5	16	10.7	200	120	50	N/A	190	Electricity	YES	Ground/Carpet
HALL III 3	181	5.5	16	11.4	215	130	50	N/A	200	Electricity	YES	Ground/Carpet
HALL IV 4	181	5.5	16	11.4	215	130	50	N/A	200	Electricity	YES	Ground/Carpet

6 WC **7** Conference Reception

Additional Notes

1 N/A means Not Available.

2 "Electricity" in the Lighting field means that lighting is artificial.

3 All dimensions are indicated in SI, that means in meters where length is concerned or square meters where surface is concerned.